

# "PALISADE W PALE" FENCE

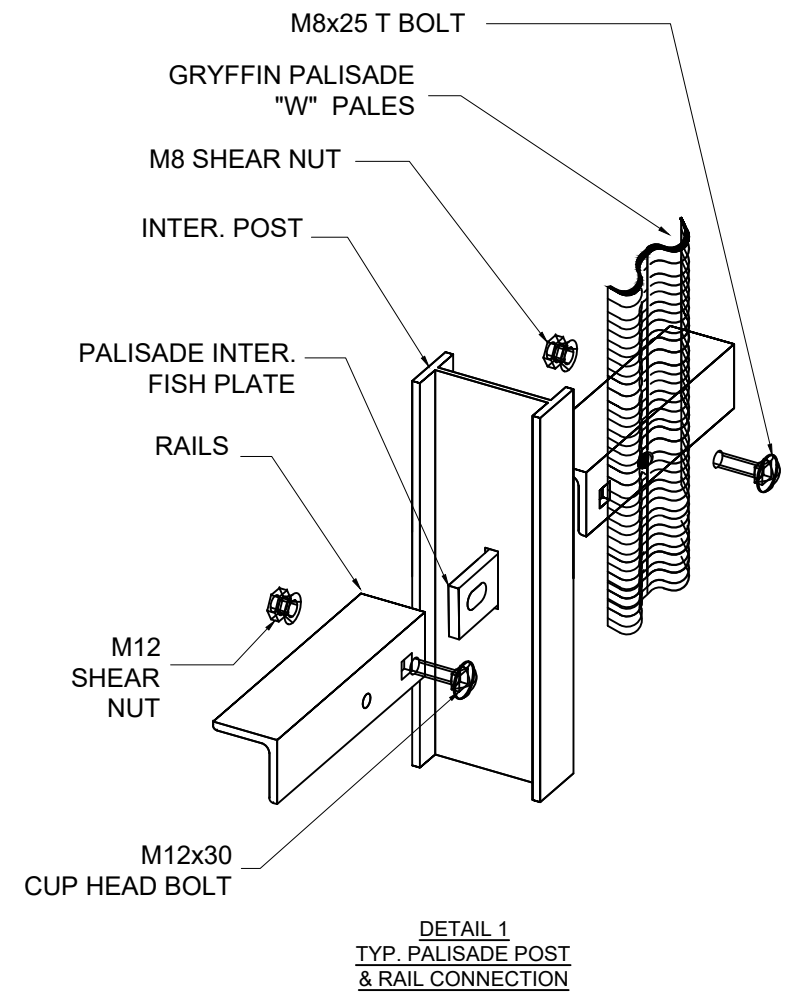
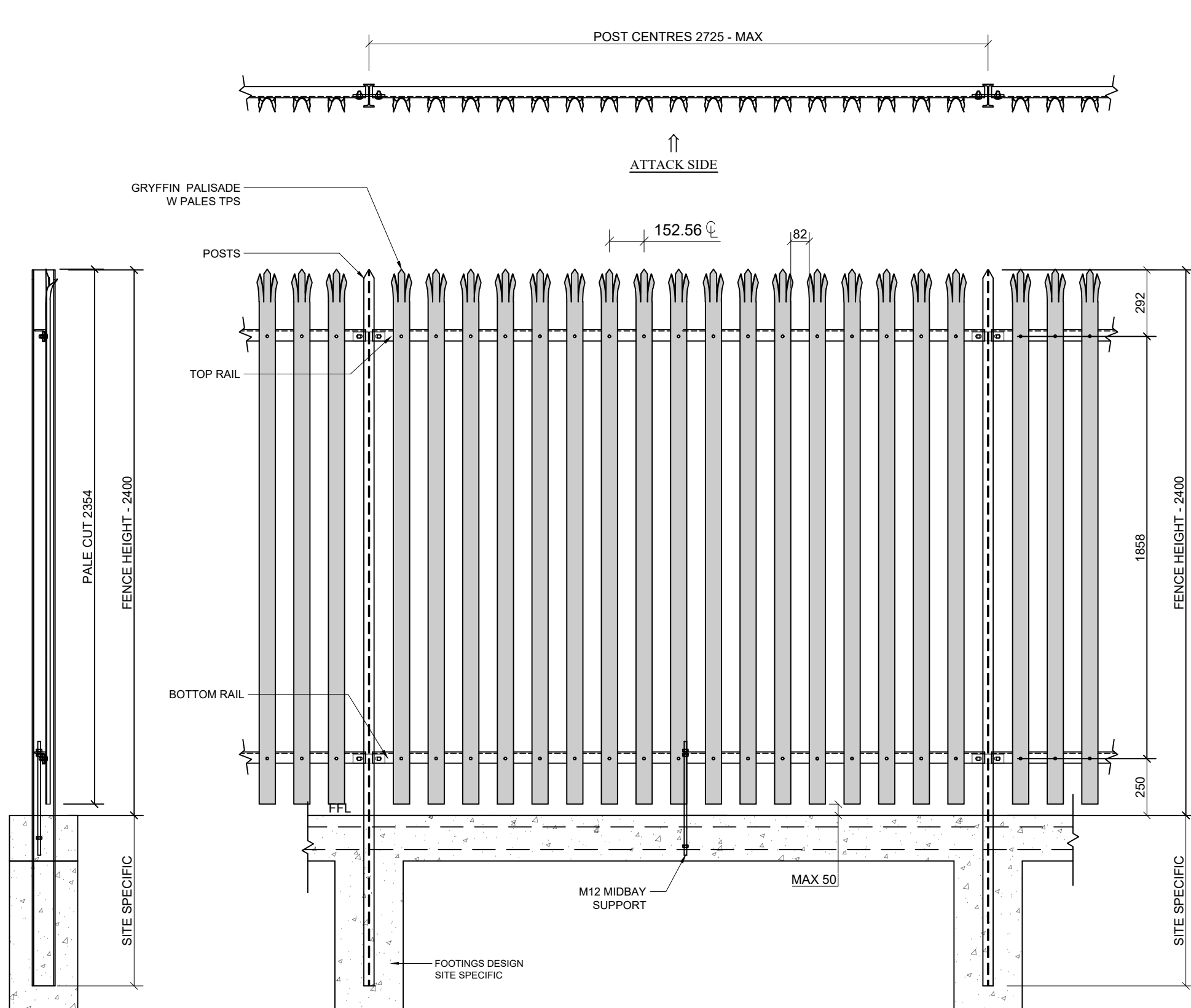

**Standard Fence Pale Material**  
 HA300 for BS1722-12 2006 SP Grade  
 HA250 for BS1722-12 2006 GP Grade  
 HA3, Brightform or SPHC for Gryffin Commercial Grade  
 Yield strength: SP 320-380 MPa, GP 220-330 MPa  
 Tensile strength: SP 450-500 MPa, GP 340-370 MPa  
 Yield & Tensile strength for Commercial Grade confirmed at time of inquiry as they are subject to the steel type and availability.

**Standard Fence Post Material**  
 Tapered Flange Beam (TFB) 100 x 45mm x 7.20kg/m or similar up to 2.7m in height. Grade 300 plus, Minimum tensile strength 440 MPa. Material to Australian Standard AS 3679.1-300.

**Standard Fence Rails**  
 Equal Angle 50 x 50 x 6mm x 4.46 kg/m.

Hot dip galvanized after fabrication to A.S. 4680 - 2006.  
 Manufactured to British Standard BS1722-12 2006.



This drawing includes the principles of design and is submitted by **AUSTRALIAN SECURITY FENCING PTY LTD** with the agreement that it not to be reproduced, copied or loaned in part or whole. It is not to be used in any manner that may constitute a detriment directly or indirectly to **AUSTRALIAN SECURITY FENCING PTY LTD**. Acceptance of this drawing will be construed as an agreement to the above.

**Australian Security Fencing PTY LTD**  
 138 Fairey Road  
 South Windsor NSW 2756  
 Telephone: (02) 4577 9633  
 Email: sales@asf4u.com.au

Dwg No: ASF-WP-2.4-GA		
Drawn: KP	Checked: JWR	Approved: SJR
Date: 04/12/2024		Scale: NTS

**"PALISADE W PALE" FENCE  
 GENERAL ARRANGEMENT**

A/O No: 00000
Sheet:
Rev: A